



BLUETOUCH.

Child's electric motorcycle

USER GUIDE

Thank you for purchasing a child's electric motorcycle.

This electric rover will provide your child with hours of fun and miles of enjoyment 'et. Read this manual before using and operating the e-bike. Follow the safety recommendations to avoid the risk of injury to your child or third party. Do not use the e-trolley on public roads. The child should be supervised by an adult.

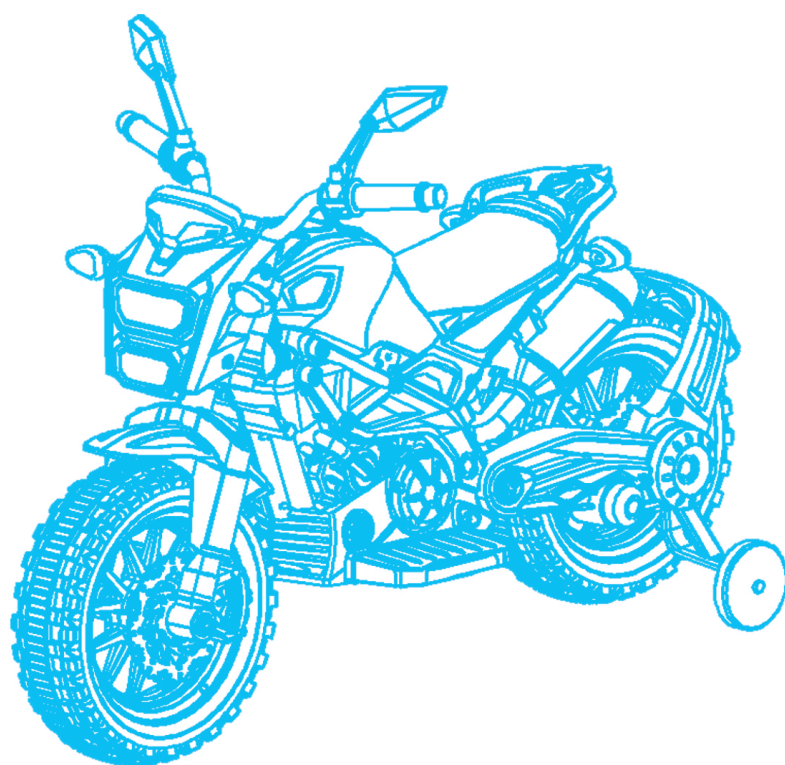

Alert

Read this manual carefully before use. It contains important information that must be observed. Keep it in a safe place for future use. Failure to follow the instructions may endanger the safety of children.

- Make sure the toy is always used under supervision.
- This toy is not intended for use in transport on public roads.
- Avoid use in damp or wet environments.



Specifications:

Child's electric motorbike BLUETOUCH

Battery parameters	2 x 6V 4.5Ah
Charger parameters	input AC 110-240 V/50/60 HZ, output DC 12 V
Engine	12 V 45W
Suitable for age	3-8 years
Battery life	1-2 hours
Charging time	8-12 hours
Max. load capacity	25 kg
Fuse	self-acting
Dimensions of the trolley	115 x 38 x 70 cm

Contents of the package

ID	Name	Number of Pcss
1	Body	1 pcs
2	Wheel	2 pcs
3	Left rear fork flat	1 pcs
4	Right rear flat fork	1 pcs
5	Back fender	1 pcs
6	Motor cover	1 pcs
7	Small wheel shaft cover	2 pcs
8	Big wheel cover	2 pcs
9	Auxiliary wheel	2 pcs
10	Rear axle sleeve	1 pcs
11	Front forks	1 pcs
12	Front bushing	2 pcs
13	Front fender	1 pcs
14	Front quarter	1pcs
15	Handlebars	1 pcs
16	Rear fin	1 pcs
17	Turn signal	4 pcs
18	Key	2 pcs
19	M5 Allen key	1 pcs
20	M2 Allen key	1pcs
21	Charger	1 pcs
22	Intruccion manual	1 pcs

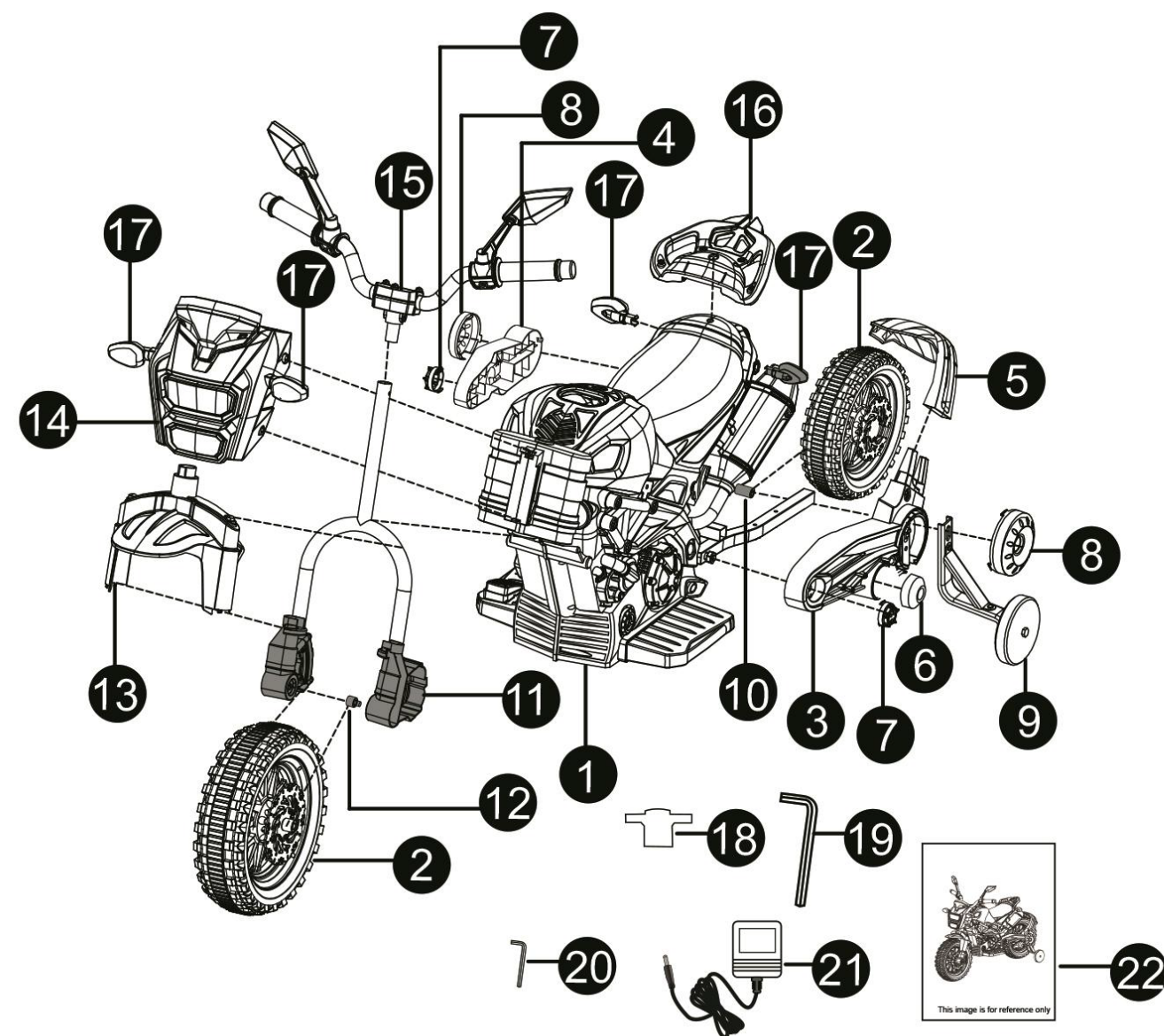

1. Instructions for assembly

Step 1 — Fixing the rear anchor to the bike body (M8x28)

- Attaching the shock absorber to the arm
- Attaching the motor and mounting the wheel
- Connecting the half-shaft and fixing the wheel

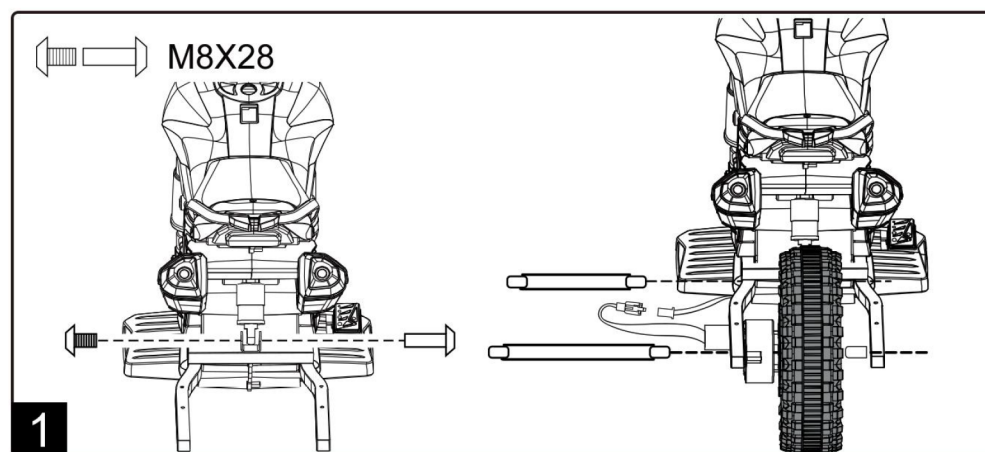

Step 2 — cover the rear wheel (2x M4x12)

- Connect the left shoulder cover and the rear fender
- Put on the right hand and engine cover and the left construction cover

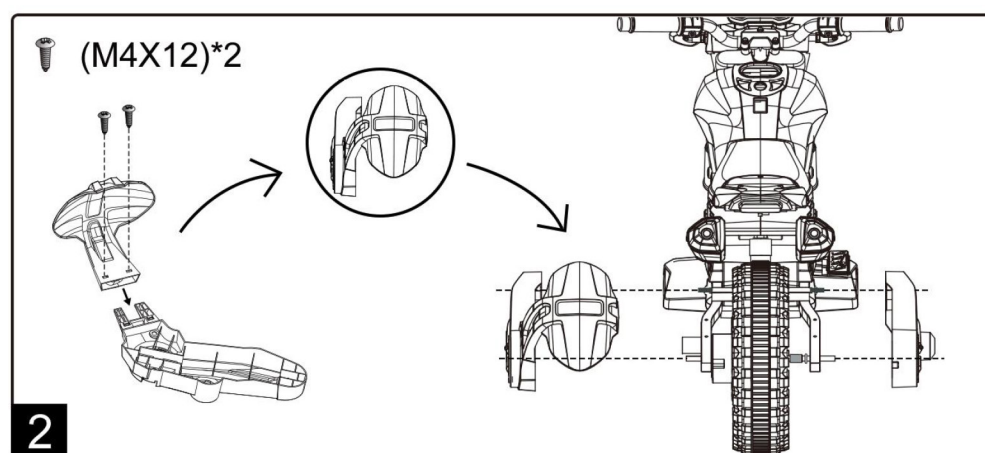

Step 3 — fixing the rear part and attaching the side wheels

- Tightening the side wheels and snapping on the cover
- Tightening the frame to the motorcycle body

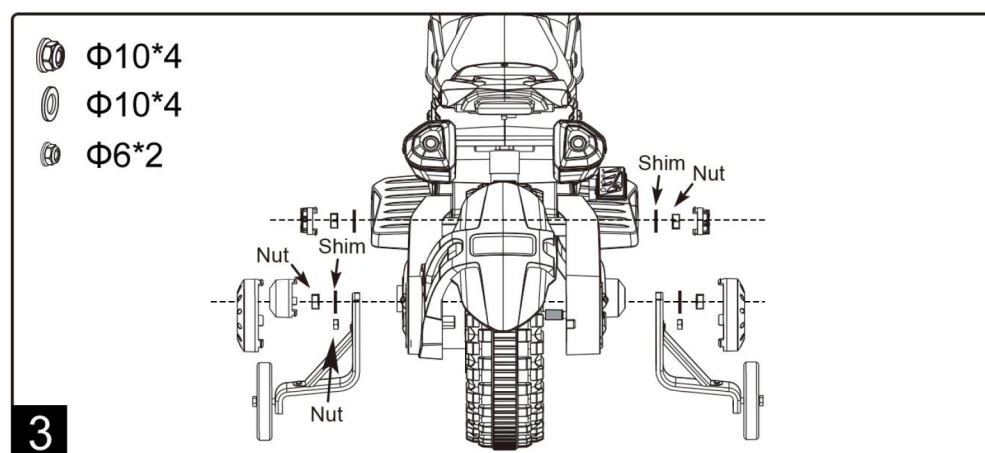

Step 4 — Assembling the front fork

- Fit the front fork to the wheel and thread the semi-axe through
- Put the front mudguard on top and click

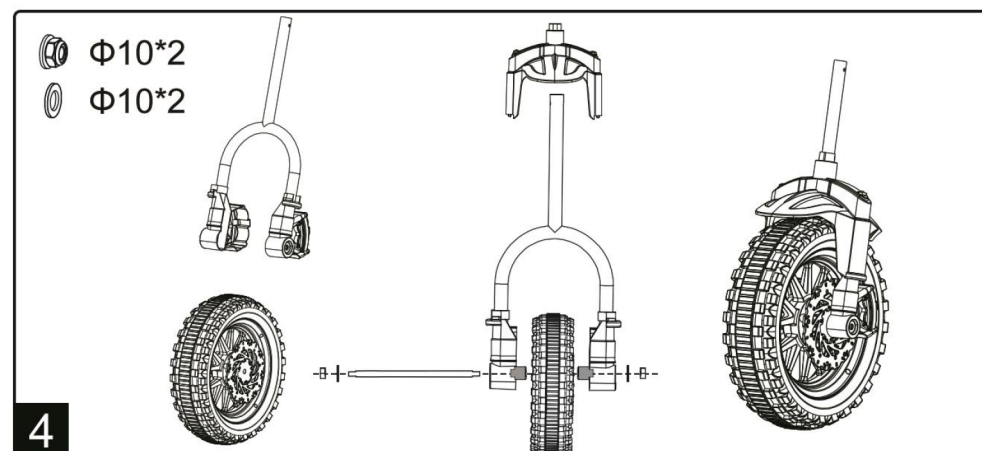

Step 5 — mounting the forks (M5x35)

- Thread the assembled fork through the bike's stem
- On one of the fork, put the bars and tighten
- Make sure the handlebars correspond to the front wheel rotation

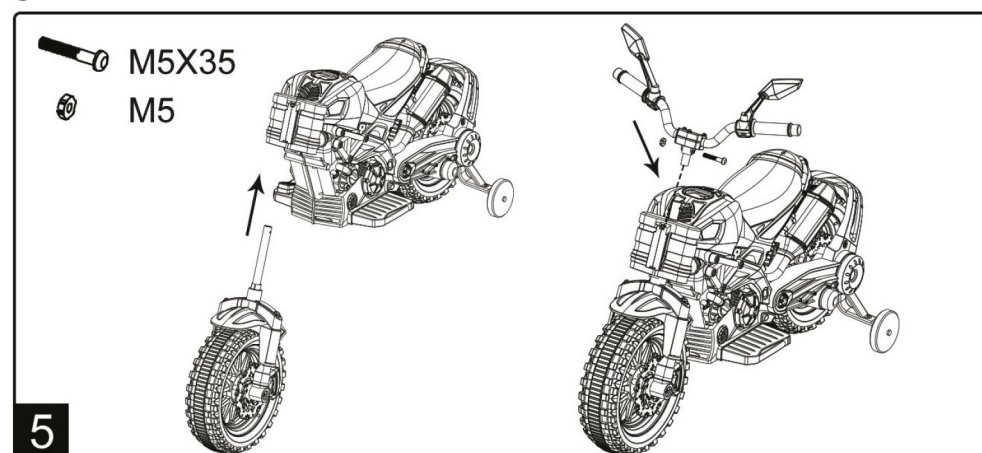

Step 6 — Completing the assembly

- Put on the front mask and connect the cable
- Fit the side plastic parts in the shape of the signal lights

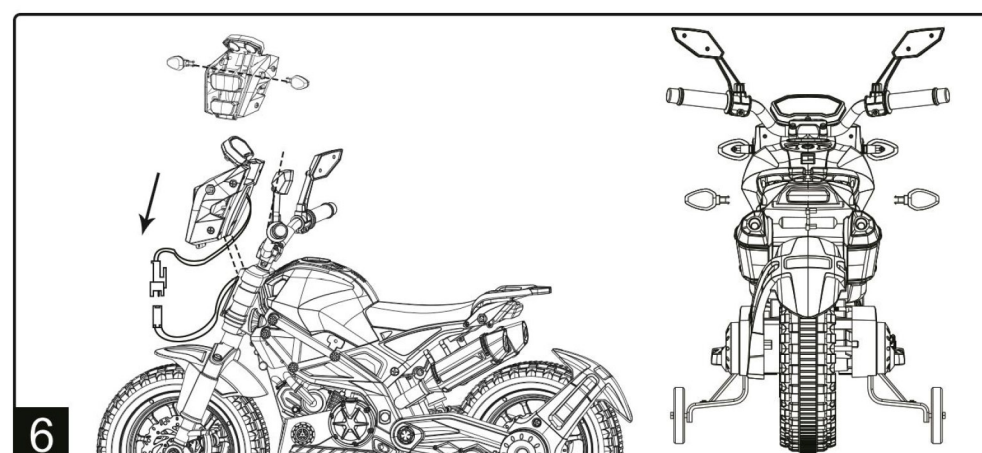

Step 7 — Connecting the battery

- a. Insert the battery and connect the battery to the motorcycle
- make sure the cable colours are the same: black+black+red+red

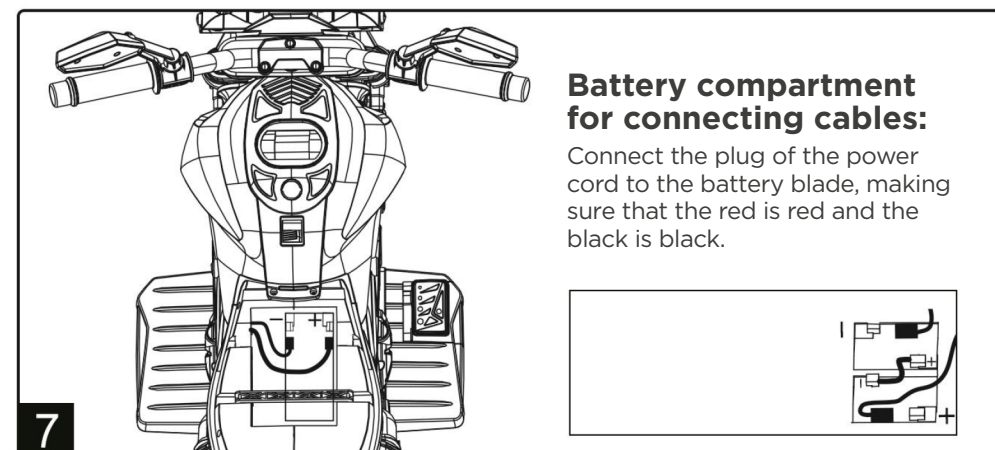

Step 8 — fitting the saddle (3x M4x12)

- a. Place the seat on the body of the bike and screw it on, the seat will cover the access to the battery compartment

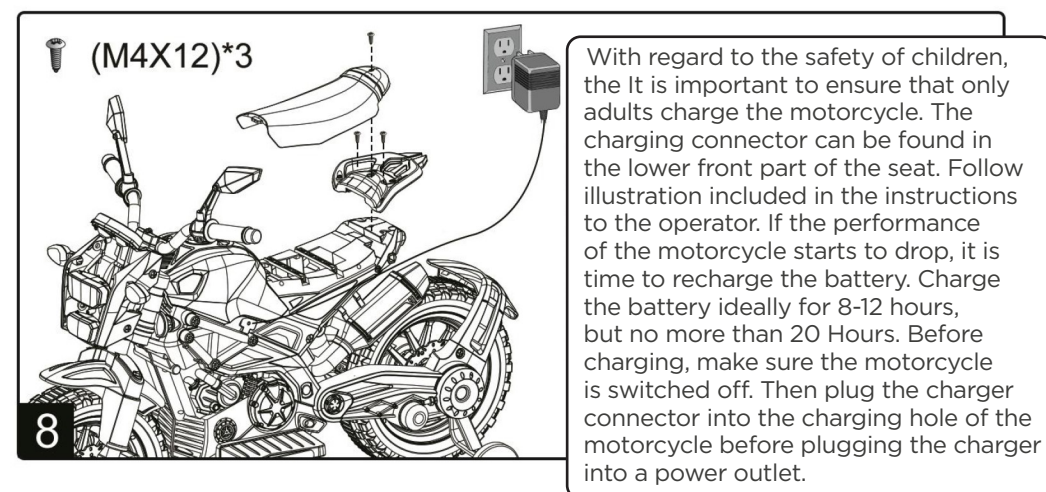

Step 9 — Replace the fuse

- a. If it is to replace the fuse, first remove the seat, then remove the self-locking fuse, and finally replace it with a new one.
- c. This product uses a renewable overload protection. If the current exceeds too high a value, the power supply is automatically interrupted and within 5-10 seconds the power supply is automatically restored.
- f. To ensure a continuous supply of electricity, it is essential that this product is not overloaded beyond its capacity limits. Ensure that it does not exceed the recommended values specified by the manufacturer. This will prevent possible blowing of the fuse and subsequent interruption of supply.

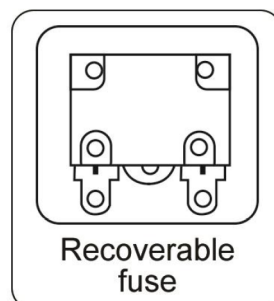

COMMENT:
Self-acting fuse has a value of 10 A

2. Description of buttons and their functions

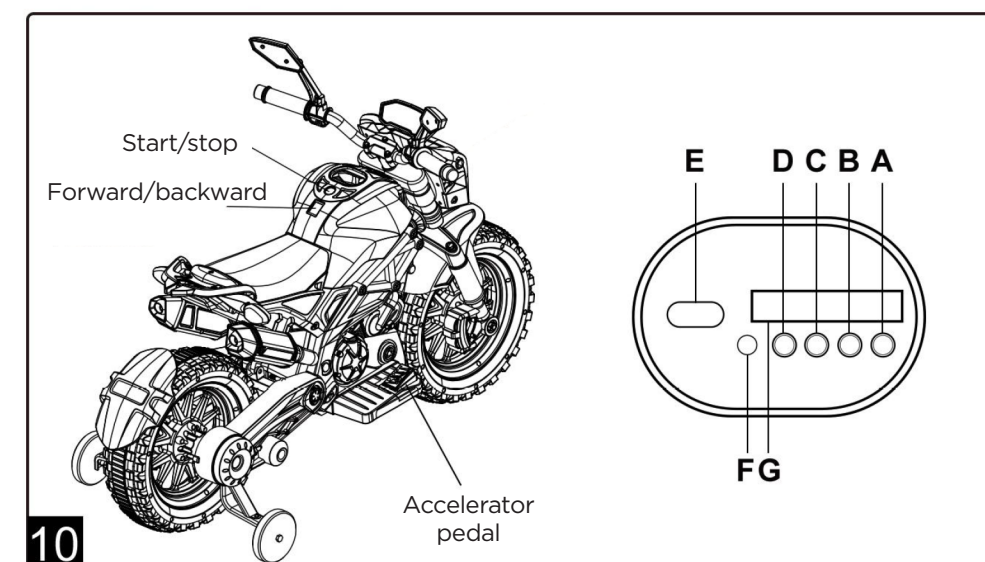

Mp3 player:

- A Switches between music and Bluetooth mode.
B Music mode/Long press to increase the volume.
C Narrative mode Příběhů/Long press of the pause switch.
D Preschool education function/Long press to lower the volume.
E USB slot; MP3 format support only
F Use the AUX input to play music from a mobile phone or other device
G The display shows the charge level when the bike is stopped. If the four lights are on, the bike is fully charged

Driving:

- The forward switch** - the bike goes forward when the pedal switch is pressed
Reverse switch - motorcycle goes in reverse when the pedal switch is pressed
Pressed Stop switch - motorcycle does not start when the pedal switch is pressed

COMMENT:

When reversing, first bring the bike to a complete stop, then start reversing. Otherwise the machine may be damaged.



3. Safety Warning

1. Before you allow your children to play with the motorcycle, read the manual carefully and try the controls yourself.
2. Never drive the motorcycle on roads, near water or in.
3. Children should ideally use a helmet when playing.
4. Avoid getting the remote wet to prevent damage to the driver.
5. Use the same type of battery and avoid combining old and new batteries.
6. If you will not be using the remote control for an extended period of time, remove the batteries.
7. Make sure that the remote control does not fall off the stalk onto the ground.
8. Check the correct polarity of the battery in the motorcycle.
9. Only adult may charge the battery.
10. Dispose of spent batteries in an environmentally friendly manner.
11. The motorcycle is not intended for children under 3 years of age.
12. If the range of the remote control falls below 3 metres, it is time to change the battery.
13. Before charging the charger, check the condition of the charger.
14. When riding a motorcycle, make sure it is not overturned. Also avoid collision with a person or animal.
15. The motorbike is intended for use by one child only. Do not overload the bike! Highest recommendation load capacity is 25 kg!

Important note on charging

- Use only the charger and battery supplied by the manufacturer.
- Avoid combining old and new batteries or different types of batteries.
- Avoid short-circuiting the battery.
- Observe the correct polarity when connecting the battery and store it neatly.
- Before charging, carefully check the condition of the charger, battery and connector. If you find any damage, do not use them.
- Slight heating during charging is normal, but a significant increase in temperature may indicate a problem with the charger, battery or internal circuitry.
- Secure the battery so that it does not fall out when the tank is properly boiled.
- Dispose of used batteries properly and recycle them.
- If the product will not be used for a long time, store it fully charged in a safe and dry place and recharge its battery once a month. This will prolong its life and avoid damage to the battery.
- Chargers are not intended for play, keep them out of the reach of children.



WARNING:

- Use only the battery and charger for charging, that are designed for this product and were part of the package.



Disposal of batteries

The battery will lose its ability to hold a voltage over time. Depending on the amount of use and various conditions, the battery should last one to three years.

Recycle the dead battery responsibly. The battery contains electrolyte and must be disposed of properly and legally.

To avoid losing your horse, follow these instructions:

- Do not overload the e-cart.
- Don't drag anything behind the e-cart.
- You don't ride in steep terrain.
- Do not bump into solid objects that can cause the wheels to spin and cause the engine to lose speed.
- Do not drive in very hot weather, the components may overheat.
- Do not allow water or other liquids to come into with the battery or other electrical components.

4. Maintenance

1. Check the main parts of the bike for damage before putting it into. If anything is not in order, do not use the product.
2. Occasionally lubricate the metal parts to prevent rust. Store the motorcycle at a safe distance from heat sources and sunlight. Do not use behind It's raining.
3. Keep the motorcycle away from a source of high temperatures to prevent deformation of its plastic parts. Also avoid charging the battery near combustible materials.
4. After each use, charge the battery and recharge it regularly to prolong its life.
5. Clean the surface of the motorcycle with a soft cloth together with a non-aggressive cleaning agent. Do not wash it with a stream of water and do not use soap.
6. Always switch it off when not in use.
7. Use only fuses of appropriate parameters.
8. Do not make any unprofessional adjustments or repairs to the bike yourself. Always consult a professional.
9. Use the motorcycle only as described in this manual.
10. Avoid short-circuiting the battery and do not recharge batteries that are not designed for this purpose.
11. Charge rechargeable batteries under supervision.
12. Dispose of spent batteries in an environmentally friendly so that they cannot be accessed by children.
13. If you are not going to use the motorcycle for a long time, remove the battery and keep it out of the reach of children.

5. Troubleshooting

PROBLEM	POSSIBLE CAUSE	SOLUTION
Motorcycle doesn't move	Battery voltage too low	Recharge the battery
	Fuse protection activated	Stop using for a few minutes
	Loose wheel nuts	Retighten the nuts
	Loose battery socket	Reconnect
	Faulty battery	Replace the battery
	Electrical damage	Service center maintenance
	Broken motor	Service center maintenance
The battery is not charging	Disconnected battery connectors	Reconnect
	Charger not powered	Reconnect
	Faulty charger	Replace the charger
Short range	Battery not fully charged	Recharge the battery
	Old batteries	Replace the batteries
Slight noise/heat during charging	Chemical reaction	Normal condition
Low speed	Used battery	Replace the battery
	Discharged batteries	Recharge the battery
	Overload	Replace the battery
	Uneven surface	Ride on a flat surface
Gearbox noise	Broken gear	Service center maintenance
Motorcycle vibrates during ride	Poor motor cable contact	Reconnect
	Faulty motor part	Service center maintenance
Motorcycle is quiet	Loose handlebar connection	Reconnect
Motorcycle doesn't stop	Electrical damage	Service center maintenance

Product Disposal

Please do not dispose of this electric vehicle in regular municipal waste. The crossed-out wheeled bin symbol indicates that, when discarded, it is considered electrical and electronic equipment (WEEE) under Directive 2012/19/EU. For the safe disposal of electrical and electronic equipment, thank you for your cooperation in protecting the environment.

Declaration of Conformity

Bluetouch s.r.o., the manufacturer of this children's electric motorcycle, hereby declares that this device complies with the relevant provisions of EU directives, as well as harmonized and national standards, regulations, and government decrees.

This declaration of conformity is based on the following standards and certificates, verified by test reports. The device meets the requirements of the following standards or specifications:

- **EN IEC 55014-1:2021:** Electromagnetic Compatibility - Requirements for Household Appliances, Electric Tools, and Similar Devices, Part 1: Emissions
- **EN IEC 55014-2:2021:** Electromagnetic Compatibility - Requirements for Household Appliances, Electric Tools, and Similar Devices, Part 2: Immunity - Product Family Standard
- **EN IEC 61000-3-2:2019+A1:2021:** Electromagnetic Compatibility (EMC) - Part 3-2: Limits - Limits for Harmonic Currents (Equipment Input Current ≤ 16 A per Phase)
- **EN 61000-3-3:2013+A1:2019+A2:2021:** Electromagnetic Compatibility (EMC) - Part 3-3: Limits - Voltage Changes, Voltage Fluctuations, and Flicker in Public Low-Voltage Supply Systems, for Equipment with Rated Current ≤ 16 A per Phase and Not Subject to Conditional Connection

Homola M.
Martin Homola
 Prague 31th of January

BLUETOUCH.
 BLUETOUCH, S.R.O.
 U HRANIC 3221/18
 100 00 PRAHA 10
 IČ 09437223
 DIČ CZ09437223

Manufacturer

BlueTouch, s.r.o., Zelený pruh 1974/109, Praha 4, 140 00, Czech republic
 info@bluetouch.cz, ID: 094 37 223, VAT: CZ094 37 223

Having issues
with your motorcycle?

**SIMPLE AND SPEEDY
COMPLAINT PROCESS**



www.bluetouch.cz/servis



BLUETOUCH.



BLUETOUCH.

bluetouch.cz
www.bluetouch-scooters.com
www.bluetouch.sk
www.bluetouch.hu