



Specification

Excavator for children	
Battery Parameters	12 V/12 Ah
Suitable for ages	3 – 8 years
Maximum load capacity	30 kg
Dimensions	130 × 58 × 83 cm
Speed	2 – 5 km/h
Battery life	After full charge (approx. 8-12 hours) 1-2 hours of continuous operation.
Charger parameters	AC input 110-240 V; DC output 12 V-1 A/1.5 A/24 V-1 A/1.5 A
Fuse	Self-locking fuse

Notice

Read these instructions thoroughly before use. It contains important information that you need to follow. Keep it in a safe place for future reference. Failure to follow instructions may endanger the safety of children.

- **Make sure the toy is always used under adult supervision.**
- **This toy is not intended for use in traffic or on public roads.**
- **Avoid use in wet conditions.**



Package Content – Parts Diagram

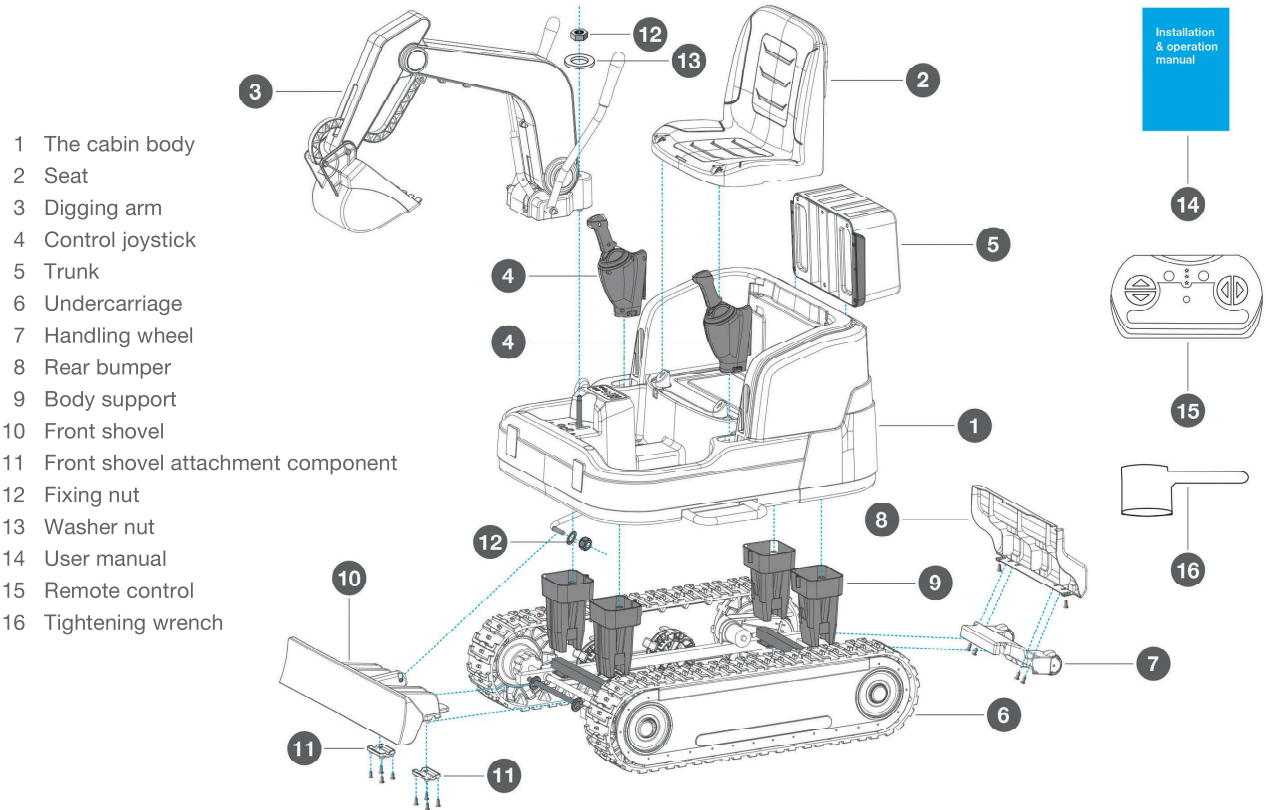

Instructions for assembly

Step 1 Cabin chassis connecting pillars (bolt M3.5×12, 16 pcs)

- a) Remove the screws at the marked locations.
- b) Pull the plug of the cable leading from the engine through the square hole in the cab
- c) Attach all 4 chassis connecting pillars to the cab body with 16 screws

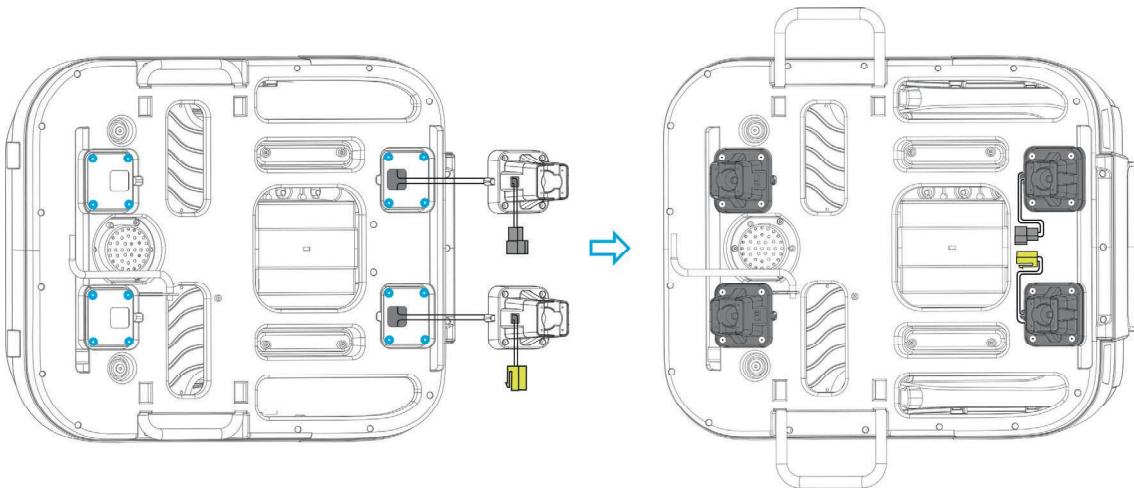



EN

Step 2 Chassis (bolt M3.5 × 12, 16 pcs.)

- Remove the screws at the highlighted points
- Attach the chassis to the cab with the screws
- Connect the chassis to the engine using plugs with the appropriate connectors

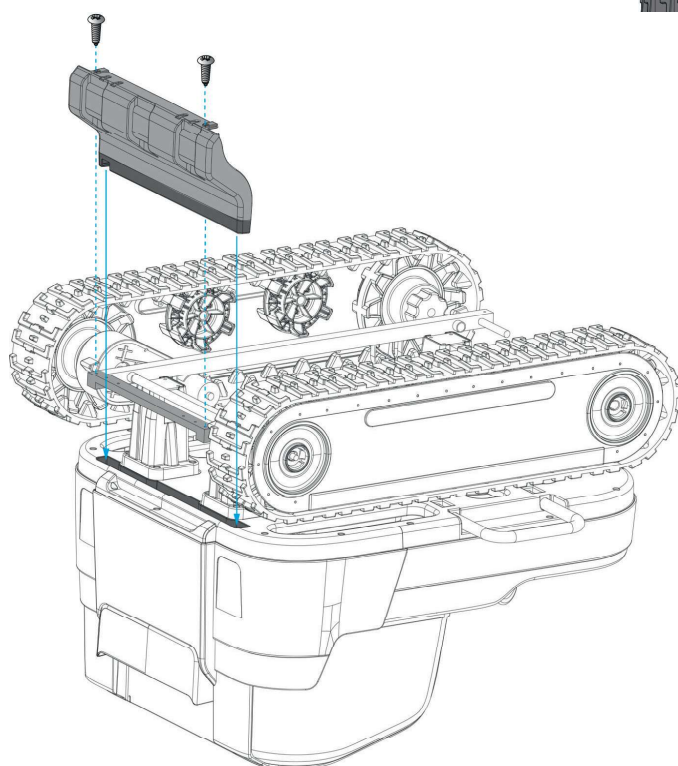
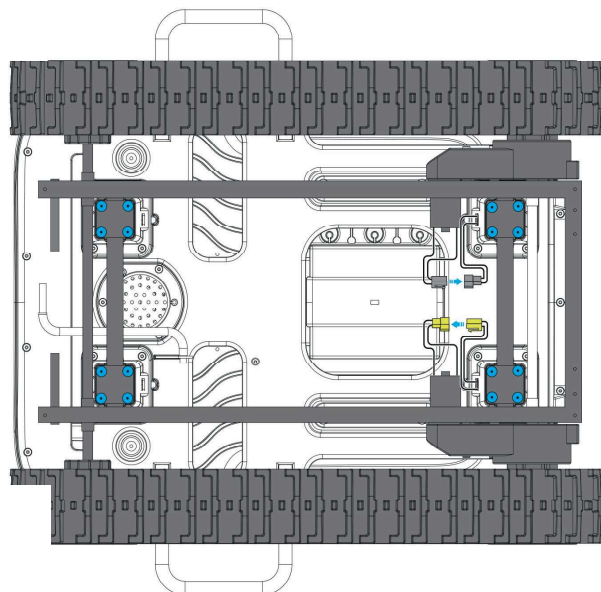

Step 3 Rear bumper (screw M4 × 12, 2 pcs.)

Step 4 Front shovel and handling wheels

Screw M3 × 12, 8 pcs.

Screw M4 × 12, 4 pcs.

Nut M8, 1 pcs.

Washer M8, 1 pcs.

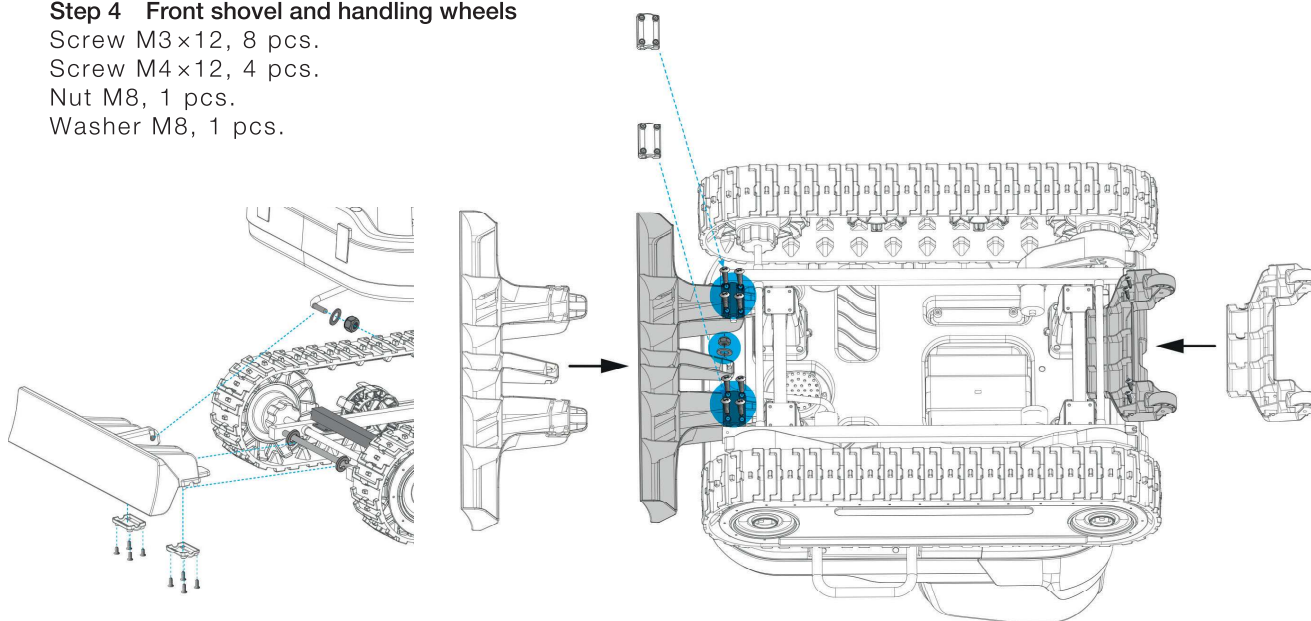



Step 5 The Bucket Arm and Control Joysticks

Nut M8, 1 piece

Washer M8, 1 pcs.

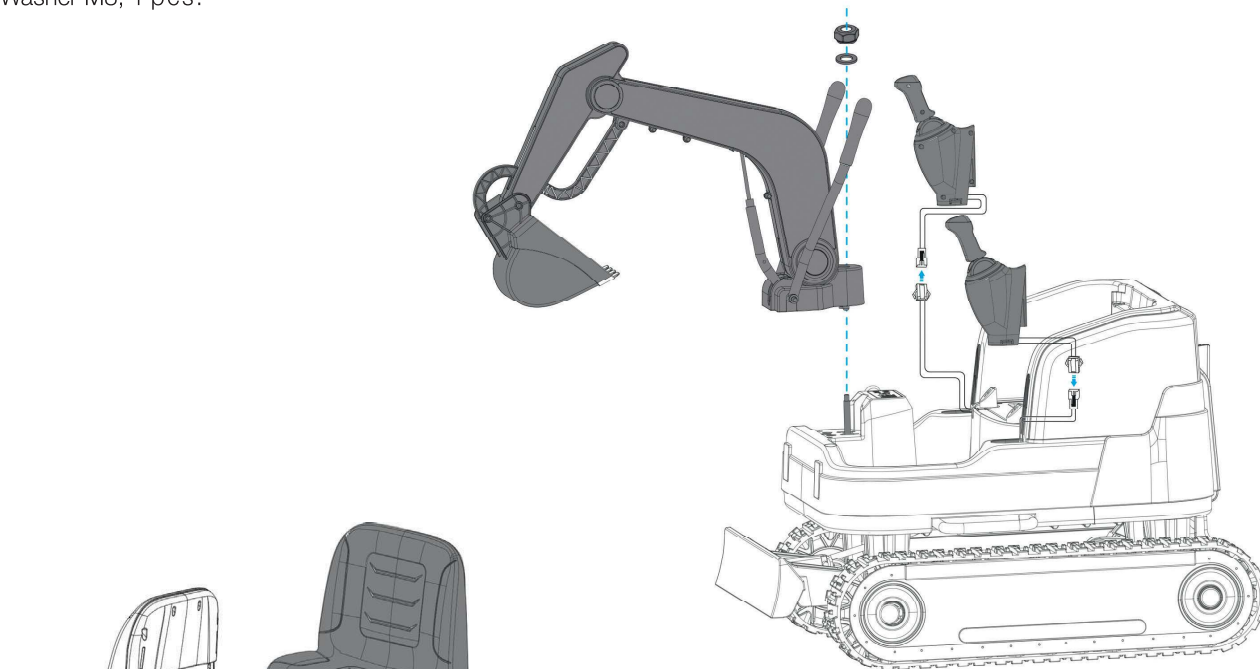

Step 6 Battery and seat

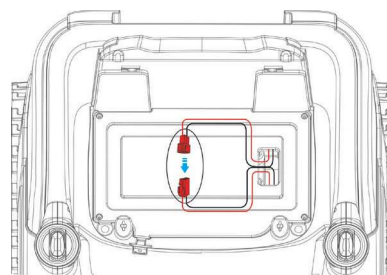
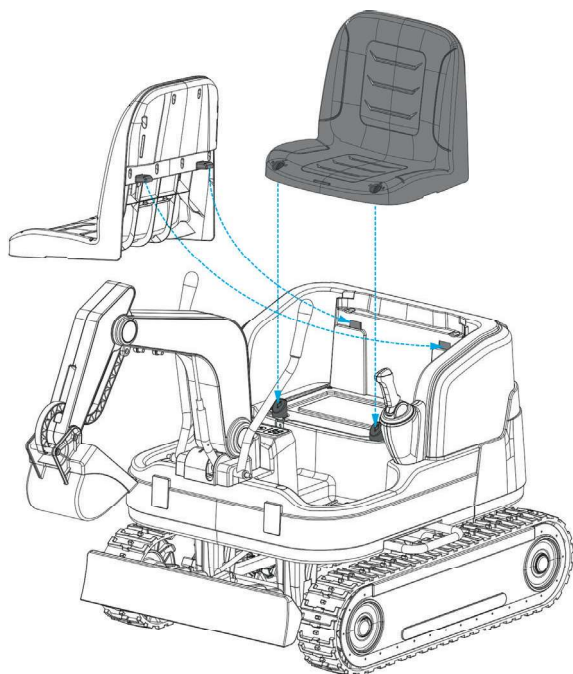

Step 7 Trunk (Screw M3.5x 12, 2 pcs.)

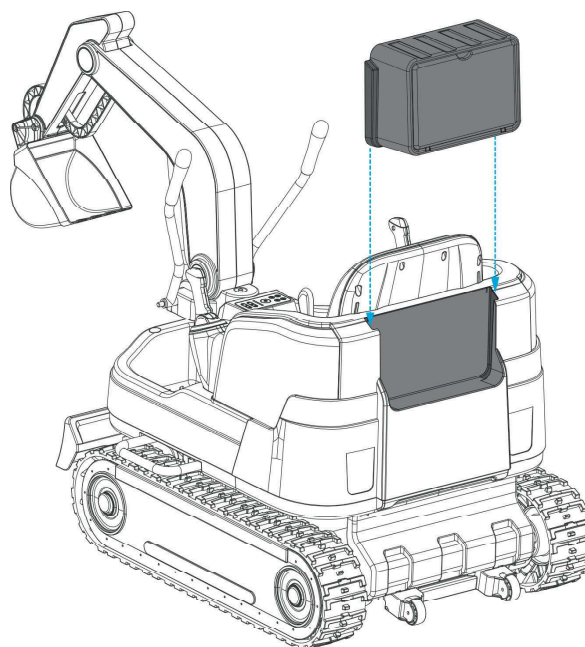



Description of the Control Panel

EN

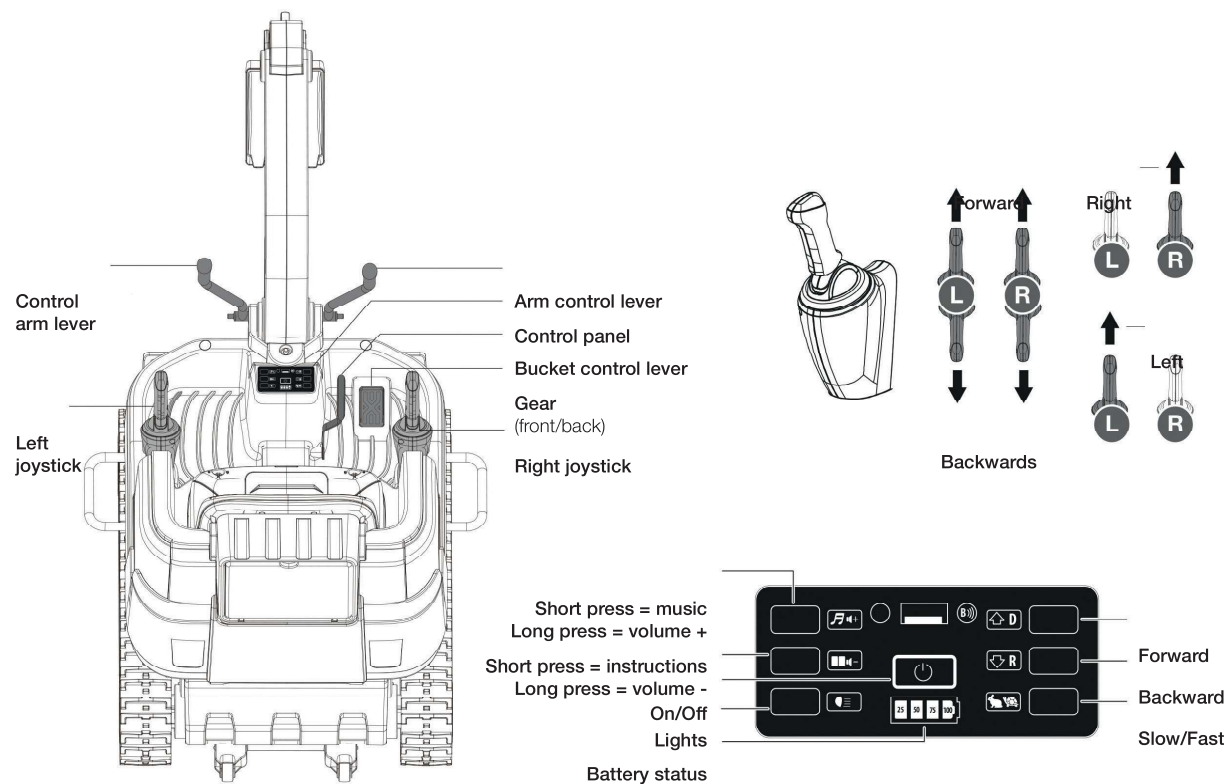
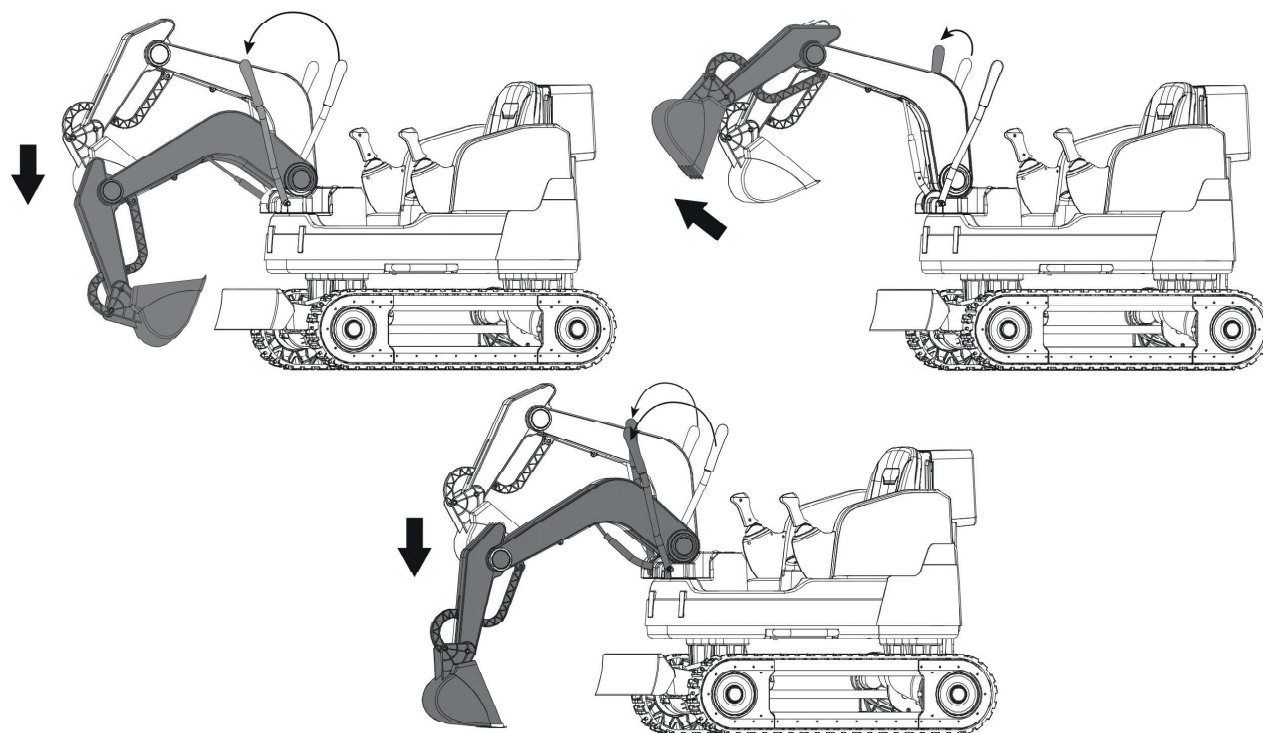

Diagram of arm control





Remote controller

Pairing the controller with the excavator

NOTICE:

The remote control must be paired before first use and after each battery change.

1. Switch off the excavator.
Press and hold the „Code“ button on the remote control.
2. Switch on the excavator. The LEDs on the remote control will flash.
3. Paired.

Status lights indicate vehicle speed:

- 1 LED: Low speed
- 2 LED: Medium speed
- 3 LED: High speed

If you press the Brake button, all LEDs will flash.

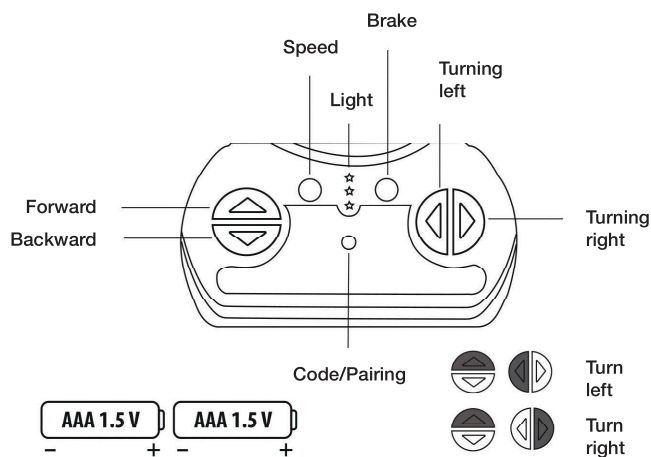

Safety notice

1. The range of the remote control from the car is 10 m. Do not move away from the toy car at a longer distance.
2. Only adults may use the remote control. Keep it out of the reach of children.
3. Before allowing children to play with the excavator, read the instructions carefully and try out the operation of the excavator yourself.
4. Never drive the excavator on roads, near water or in traffic.
5. Children should use a helmet when playing.
6. Avoid getting the remote control wet to prevent damage to the wires.
7. Use the same type of batteries and avoid combining old and new battery packs.
8. If you will not be using the remote control for an extended period of time, remove the batteries.
9. Make sure that the remote control does not fall from a height to the ground.
10. Check the correct polarity of the battery inserted in the excavator.
11. Only an adult may charge the battery.
12. Dispose of discarded batteries in an environmentally friendly manner.
13. The excavator is not intended for children under 3 years of age.
14. If the range of the remote control falls below 3 metres, it is time to change the batteries.
15. Check the condition of the charger thoroughly before charging.
16. When driving the excavator, make sure it is not tipped over. Also avoid hitting a person or animal.
17. The excavator is intended for use by one child only. Do not overload the excavator!

The maximum recommended load capacity is 30 kg!



Charging

For the safety of children, it is important to ensure that only adults charge the excavator. Charging connector is located at the bottom front of the seat. Follow the illustration included in the operating instructions. If the power starts to drop, it is time to recharge the battery. Ideally, charge the battery for 8-12 hours, but no more than 20 hours. Before charging make sure the excavator is switched off. Afterwards, plug the charger connector into the charging socket of the excavator and then plug the charger into the electrical outlet.

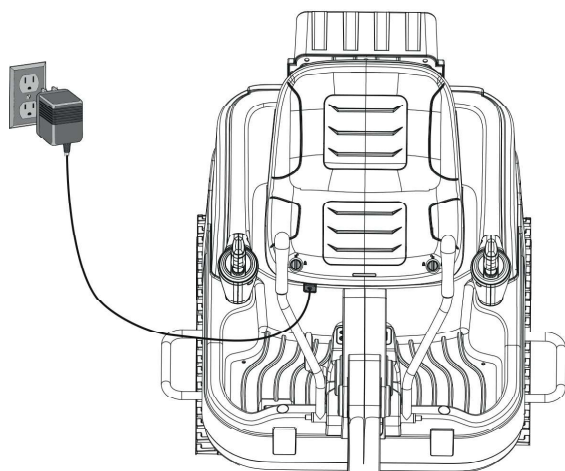
**NOTE:**

Automatic fuse has a value of 20/23 A

Replacing the fuse

1. If the fuse is necessary to be replaced, first remove the seat, then remove the self-locking fuse, and finally replace it with a new one.
2. This product uses a renewable overload fuse. If the current exceeds too high, the power supply is automatically cut off and within 5 to 10 seconds the power supply is automatically restored.
3. To ensure a continuous supply of electricity, it is essential that this product is not overloaded beyond its capacity limits. Ensure that the load does not exceed the recommended values specified by the manufacturer. This will prevent possible blowing of the fuse and subsequent interruption of the power supply.

Important notices about charging

1. Use only the charger and battery supplied by the manufacturer.
2. Avoid combining old and new batteries or different types of batteries.
3. Avoid short-circuiting batteries.
4. Observe the correct polarity when connecting the battery and its proper storage.
5. Carefully check the condition of the charger, battery and connector before charging. If damage is found, do not use them.
6. Slight heating during charging is normal, but a significant increase in temperature may indicate a problem with the charger, battery or internal circuitry.
7. Secure the battery to prevent it from falling out if the excavator is accidentally tipped over.
8. Dispose of used batteries responsibly and recycle them.
9. If the product will not be used for a long period of time, store it fully charged in a dry place. Recharge the battery once a month. This will prolong its life and avoid damage to the battery.
10. Chargers are not intended for play. Keep them away from out of the reach of children.

Maintenance

1. Check the main parts before operation of the excavator for damage. If something is wrong, do not use the product.
2. Occasionally lubricate the metal parts to prevent rust.
3. Store the excavator at a safe distance from the of heat and sunlight. Do not use in the rain.
4. Keep the excavator away from sources of high temperatures to prevent deformation its plastic parts. Also avoid charging the battery near combustible materials.
5. Charge the battery after each use and recharge it regularly, to prolong its life.
6. Clean the surface of the excavator with a soft cloth along with a non-aggressive cleaner. Do not wash with a stream of water and do not use soap.
7. Always switch off the excavator when it is not in use.
8. Use only the appropriate fuses of the correct rating.
9. Do not make any unprofessional adjustments or repairs to the excavator. Always consult a professional.
10. Use the excavator only as specified in this manual.
11. Avoid short-circuiting the batteries and do not recharge batteries that are not designed for.
12. Charge rechargeable batteries under adult supervision.
13. Environmentally dispose of discarded batteries in a manner that prevents children from accessing them.
14. If you are not going to use the excavator for an extended period of time, remove the battery and keep it out of the reach of children.



Declaration of conformity

We, the manufacturer of this toy car, hereby declare under our sole responsibility that the equipment specified below complies with the relevant provisions of EU harmonization directives, as well as with harmonized and national standards, provisions, and regulations. This Declaration of Conformity is based on the following standards and certificates verified by test reports issued by Intertek Testing Services Shanghai.



The equipment complies with the requirements according to the following standard(s) or Specification:

- EN IEC 55014–1:2021:
Electromagnetic compatibility – Requirements for household appliances, electric tools and similar apparatus Part 1: Emission
- *EN IEC 55014–2:2021:
Electromagnetic compatibility – Requirements for household appliances, electric tools and similar apparatus Part 2: Immunity – Product family standard
- *EN IEC 61000–3–2:2019+A1:2021:
Electromagnetic compatibility (EMC) – Part 3–2: Limits – Limits for harmonic current emissions (equipment input current ≤ 16A per phase)
- *EN 61000–3–3:2013+A1:2019+A2:2021:
Electromagnetic compatibility (EMC) – Part 3–3: Limits – Limitation of voltage changes, voltage fluctuations and flicker in public low-voltage supply systems, for equipment with rated current ≤ 16A per phase and not subject to conditional connection

- *BS EN IEC 55014–1:2021:
Electromagnetic compatibility – Requirements for household appliances, electric tools and similar apparatus Part 1: Emission
- *BS EN IEC 55014–2:2021:
Electromagnetic compatibility – Requirements for household appliances, electric tools and similar apparatus Part 2: Immunity – Product family standard
- *BS EN IEC 61000–3–2:2019+A1:2021:
Electromagnetic compatibility (EMC) – Part 3–2: Limits – Limits for harmonic current emissions (equipment input current ≤ 16A per phase)
- *BS EN 61000–3–3:2013+A2:2021:
Electromagnetic compatibility (EMC) – Part 3–3: Limits – Limitation of voltage changes, voltage fluctuations and flicker in public low-voltage supply systems, for equipment with rated current ≤ 16A per phase and not subject to conditional connection

Howda M.
Petr Novák
In Prague, February 28, 2025

BLUETOUCH.
BLUETOUCH, S.R.O.
U HRANIC 3221/18
100 00 PRAHA 10
IČ 09437223
DIČ CZ09437223

Disposal of the product

Please do not dispose of this electric toy car in the common municipal waste. The symbol of a crossed-out wheelee bin means that it is electrical and electronic equipment (WEEE) subject to Directive 2012/19/EU in the case of disposal. For safe disposal, it is necessary to hand it in for recycling in accordance with local regulations for the disposal of waste electrical and electronic equipment. Likewise, please do not dispose of used batteries and accumulators in normal waste. You can take them to a collection yard or back to your dealer, who will provide you with more information about recycling and proper disposal. Thank you for your cooperation in protecting the environment.

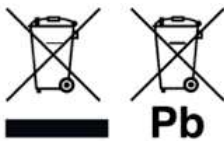

Manufacturer:
BlueTouch, s.r.o., Zelený Pruh 1974/109, 140 00 Prague 4, Czech Republic, info@bluetooth.cz
Company Registration Number (IČ): 09437223, Tax Identification Number (DIČ): CZ09437223

